



**Appendix B14**  
GNI Asset Alterations







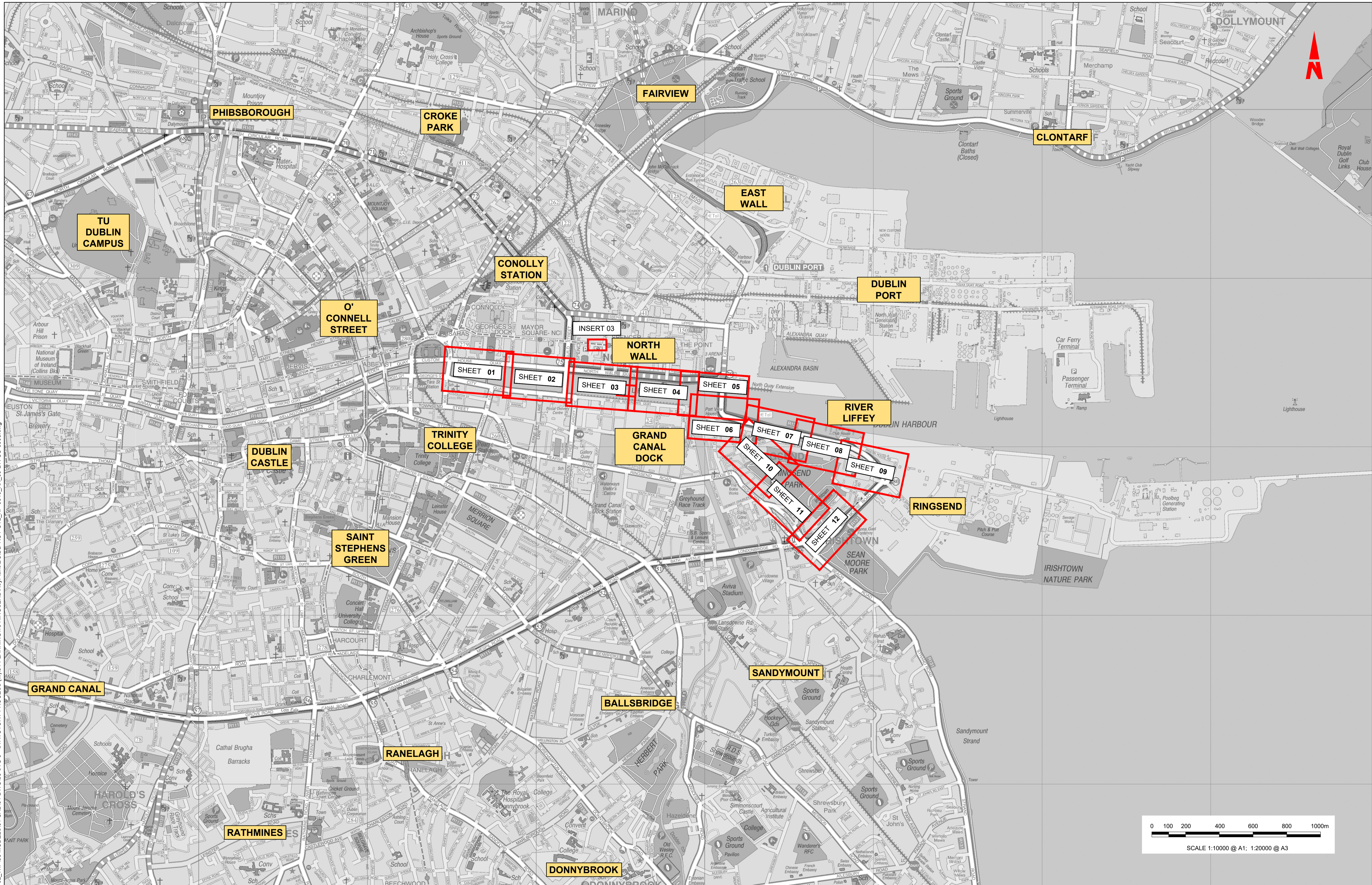

W:\000000\1917117-02\_WIP08\_MODELS\01\_CAD\01\_PLANNING\16\_RINGSEND\KeyPlans\BCIDD-ROT-UTL\_KP-0016\_XX\_00-DR-CU-0005.dwg  
 W:\000000\1917117-02\_WIP08\_MODELS\01\_CAD\01\_PLANNING\16\_RINGSEND\KeyPlans\BCIDD-ROT-UTL\_KP-0016\_XX\_00-DR-CU-0005.dwg

Disclaimer  
 a. © National Transport Authority (NTA) 2022. This drawing is confidential and the copyright in it is owned by NTA. This drawing must not be either loaned, copied or otherwise reproduced in whole or in part or used for any purpose without the prior permission of NTA.  
 b. This drawing is to be used for the design element identified in the title block. Other information shown is to be considered indicative only. The drawing is to be read in conjunction with all other relevant design drawings.  
 c. O.S. data used for plans are printed under © Ordnance Survey Ireland Government of Ireland. All rights reserved. Licence Number 2022/OSI\_NMA\_180 National Transport Authority. All elevations are in metres and relate to OSi Geoid Model (OSGM15) Mean Head. All Co-ordinates are in Irish

Transverse Mercator Grid (ITM) as defined by OSI active local GPS station.  
 d. Information concerning the position of apparatus shown on this drawing is based on the drawings supplied by the utility owners, agents and/or the utility works contractor, whilst every care has been taken in the preparation of this drawing, positions should be taken as approximate and are provided for general guidance only and no representation is made by the NTA as to the accuracy, completeness, sufficiency or otherwise of this drawing and any reliance on the information or any part of it is hereby expressly disclaimed.

The information contained herein has been provided by the NTA but does not purport to be comprehensive or final. Recipients should not rely on the information. Neither the NTA nor any of its directors, officers, employees, agents, stakeholders or advisers make any representation or warranty as to, or accept any liability or responsibility in relation to, the adequacy, accuracy, reasonableness or completeness of the information provided as part of this document or any matter on which the information is based (including but not limited to loss or damage arising as a result of reliance on the information or any part of it). Any liabilities are hereby expressly disclaimed.

Rev	Date	Drn	Chk'd	App'd	Description
M01	MAR 2023	DS	EOC	SMG	ISSUE FOR PHASE 4: PLANNING

Client  
  
 Údarás Náisiúnta Iompair  
 National Transport Authority

Engineering Designer

Drawn	Checked	Approved
DS	EOC	SMG

Programme Title  
**BUSCONNECTS DUBLIN**  
**CORE BUS CORRIDORS INFRASTRUCTURE WORKS**

Drawing Title  
 RINGSEND TO CITY CENTRE CORE BUS CORRIDOR SCHEME  
 GNI ASSET ALTERATIONS  
 KEYPLAN

Drawing File Name	Sheet Number	Status	Rev
BCIDD-ROT-UTL_KP-0016_XX_00-DR-CU-0005	01 of 01	A	M01

DO NOT SCALE USE FIGURED DIMENSIONS ONLY







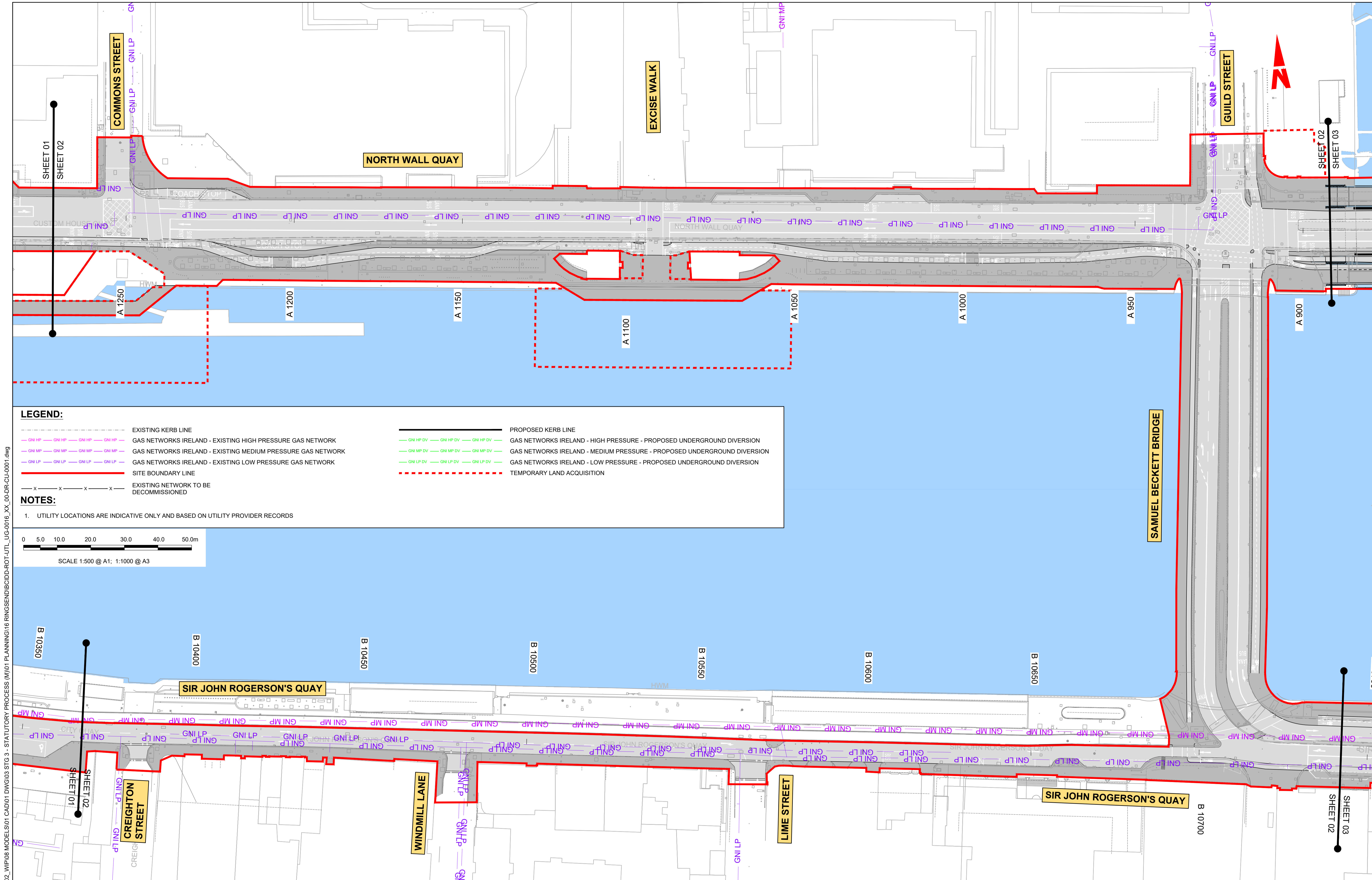

**LEGEND:**

---	EXISTING KERB LINE	---	PROPOSED KERB LINE
---	GAS NETWORKS IRELAND - EXISTING HIGH PRESSURE GAS NETWORK	---	GAS NETWORKS IRELAND - HIGH PRESSURE - PROPOSED UNDERGROUND DIVERSION
---	GAS NETWORKS IRELAND - EXISTING MEDIUM PRESSURE GAS NETWORK	---	GAS NETWORKS IRELAND - MEDIUM PRESSURE - PROPOSED UNDERGROUND DIVERSION
---	GAS NETWORKS IRELAND - EXISTING LOW PRESSURE GAS NETWORK	---	GAS NETWORKS IRELAND - LOW PRESSURE - PROPOSED UNDERGROUND DIVERSION
---	SITE BOUNDARY LINE	---	TEMPORARY LAND ACQUISITION
---	EXISTING NETWORK TO BE DECOMMISSIONED		

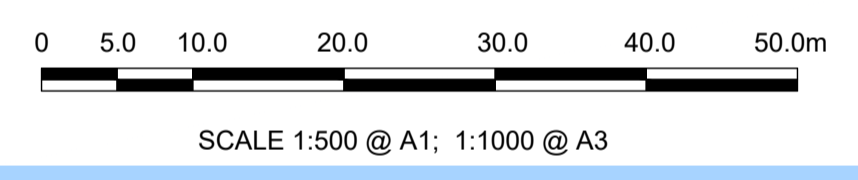

W:\000000\19171717-02\_WIP\08 MODELS\01 CAD\01 DWG\03 STG 3 - STATUTORY PROCESS (M)\01 PLANNING\16 RINGSEND\BCIDD-ROT-UTL\_UG-0016\_XX\_00-DR-CU-0001.dwg

<p><small>Disclaimer</small></p> <p>a. © National Transport Authority (NTA) 2022. This drawing is confidential and the copyright in it is owned by NTA. This drawing must not be either loaned, copied or otherwise reproduced in whole or in part or used for any purpose without the prior permission of NTA.</p> <p>b. This drawing is to be used for the design element identified in the titlebox. Other information shown is to be considered indicative only. The drawing is to be read in conjunction with all other relevant design drawings.</p> <p>c. O.S. data used for plans are printed under © Ordnance Survey Ireland Government of Ireland. All rights reserved. Licence Number 2022/OSI_NMA_180 National Transport Authority. All elevations are in metres and relate to OSI Geoid Model (OSGM15) Mean Head. All Co-ordinates are in Irish Transverse Mercator Grid (ITM) as defined by OSI active local GPS station.</p> <p>d. Information concerning the position of apparatus shown on this drawing is based on drawings supplied by the utility owners and/or the utility works contractor, whilst every care has been taken in the preparation of this drawing, positions should be taken as approximate and are intended for general guidance only and no representation is made by the NTA as to the accuracy, completeness, sufficiency or otherwise of this drawing and the position of the apparatus. The information contained herein does not purport to be comprehensive or final as the apparatus is subject to being altered and/or superceded. Recipients should not rely on this information. Any liabilities are hereby expressly disclaimed.</p> <p>e. The information contained herein has been provided by the NTA but does not purport to be comprehensive or final. Recipients should not rely on the information. Neither the NTA nor any of its directors, officers, employees, agents, stakeholders or advisers make any representation or warranty as to, or accept any liability or responsibility in relation to, the adequacy, accuracy, reasonableness or completeness of the information provided as part of this document or any matter on which the information is based (including but not limited to loss or damage arising as a result of reliance by recipients on the information or any part of it). Any liabilities are hereby expressly disclaimed.</p>		<p>Rev M01 Date MAR 2023 Dm DS Chk'd EOC App'd SMG Description ISSUE FOR PHASE 4: PLANNING</p>		<p>Client <b>NTA</b> Údarás Náisiúnta Iompair National Transport Authority</p>		<p>Engineering Designer <b>CIROD</b> TYPSA</p>			<p>Programme Title <b>BUSCONNECTS DUBLIN CORE BUS CORRIDORS INFRASTRUCTURE WORKS</b></p> <p>Drawing Title RINGSEND TO CITY CENTRE CORE BUS CORRIDOR SCHEME GNI ASSET ALTERATIONS</p>			
<p>Date MAR 2023 Scale 1:500 @ A1 1:1000 @ A3</p> <p>Programme Code BCIDD Originator Code ROT</p>		<p>Drawn DS Checked EOC Approved SMG</p> <p>QMS Code</p>			<p>Drawing File Name BCIDD-ROT-UTL_UG-0016_XX_00-DR-CU-0002</p> <p>Sheet Number 02 of 12</p>		<p>Status A</p>		<p>Rev M01</p>			

DO NOT SCALE USE FIGURED DIMENSIONS ONLY



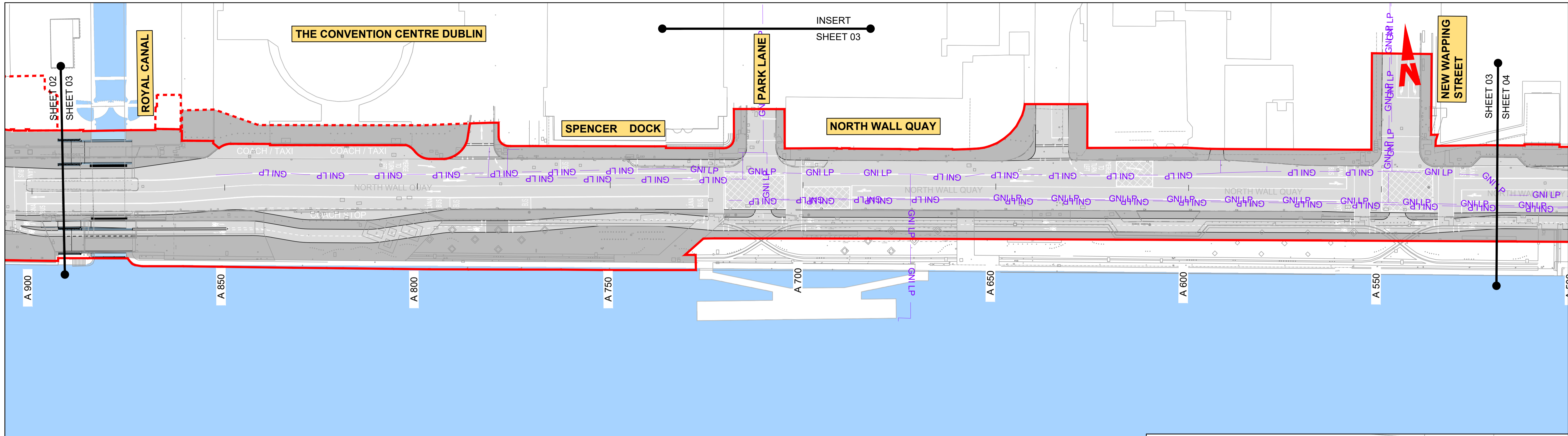

**LEGEND:**

	EXISTING KERB LINE		PROPOSED KERB LINE
	GAS NETWORKS IRELAND - EXISTING HIGH PRESSURE GAS NETWORK		GAS NETWORKS IRELAND - HIGH PRESSURE - PROPOSED UNDERGROUND DIVERSION
	GAS NETWORKS IRELAND - EXISTING MEDIUM PRESSURE GAS NETWORK		GAS NETWORKS IRELAND - MEDIUM PRESSURE - PROPOSED UNDERGROUND DIVERSION
	GAS NETWORKS IRELAND - EXISTING LOW PRESSURE GAS NETWORK		GAS NETWORKS IRELAND - LOW PRESSURE - PROPOSED UNDERGROUND DIVERSION
	SITE BOUNDARY LINE		TEMPORARY LAND ACQUISITION
	EXISTING NETWORK TO BE DECOMMISSIONED		

**NOTES:**

- UTILITY LOCATIONS ARE INDICATIVE ONLY AND BASED ON UTILITY PROVIDER RECORDS

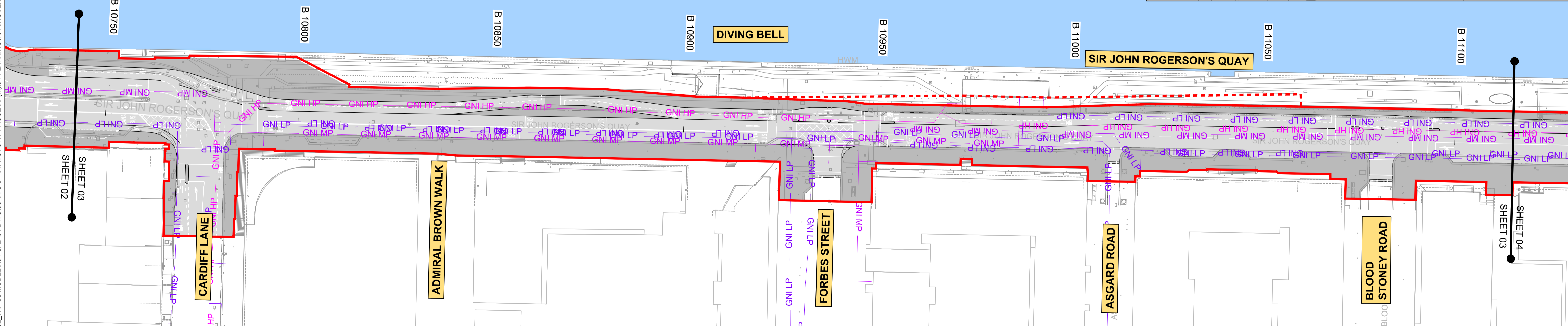
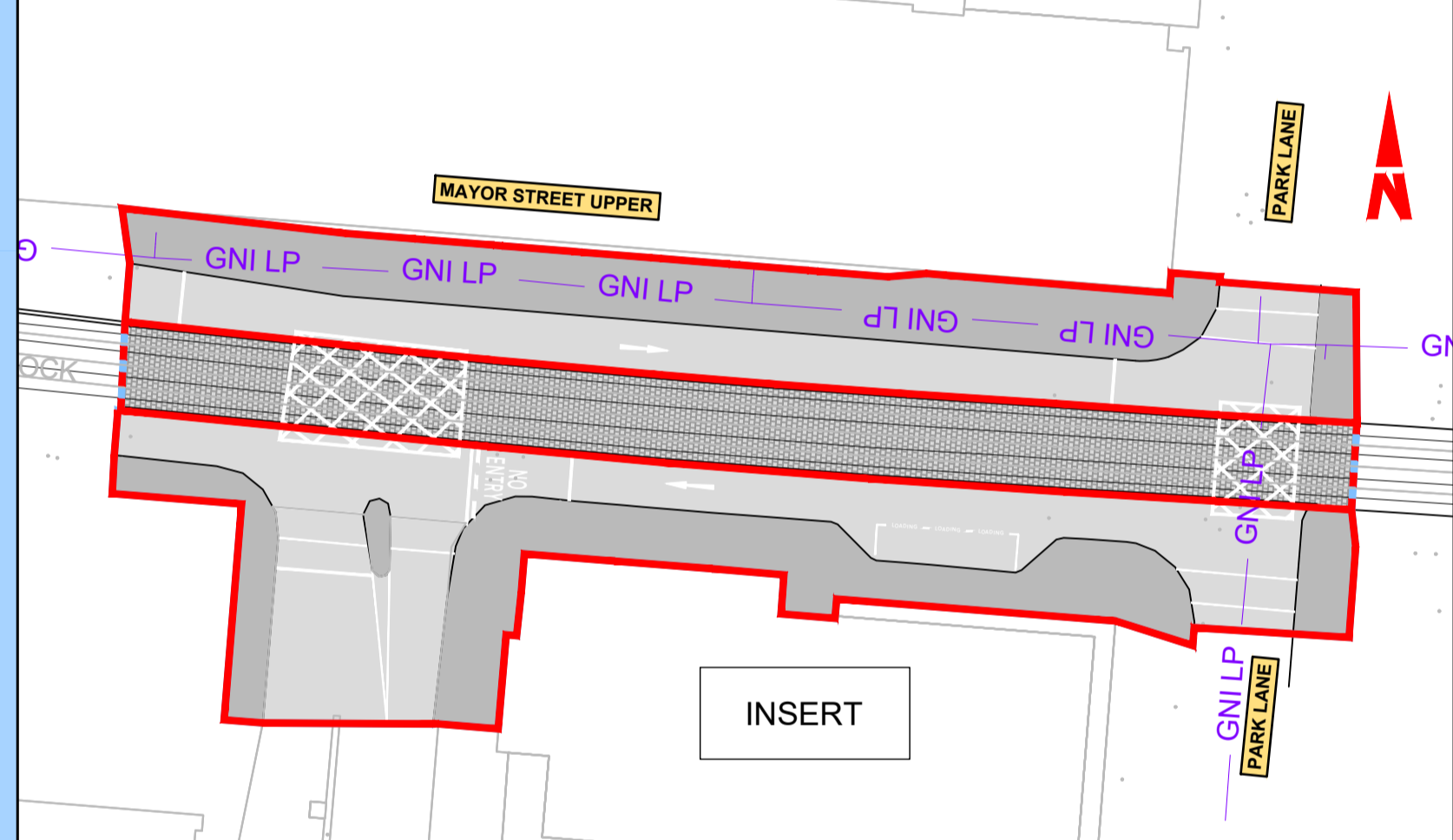
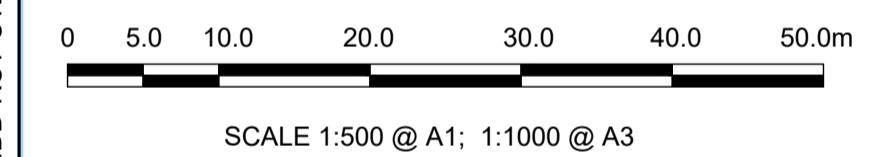

<p><b>Disclaimer</b></p> <p>a. © National Transport Authority (NTA) 2022. This drawing is confidential and the copyright in it is owned by NTA. This drawing must not be either loaned, copied or otherwise reproduced in whole or in part or used for any purpose without the prior permission of NTA.</p> <p>b. This drawing is to be used for the design element identified in the titlebox. Other information shown is to be considered indicative only. The drawing is to be read in conjunction with all other relevant design drawings.</p> <p>c. O.S. data used for plans are printed under © Ordnance Survey Ireland Government of Ireland. All rights reserved. Licence Number 2022/OSI_NMA_180 National Transport Authority. All elevations are in metres and relate to OSI Geoid Model (OSGM15) Mean Head. All Co-ordinates are in Irish Transverse Mercator Grid (ITM) as defined by OSI active local GPS station.</p> <p>d. Information concerning the position of apparatus shown on this drawing is based on drawings supplied by the utility owners and/or the utility works contractor, whilst every care has been taken in the preparation of this drawing, positions should be taken as approximate and are intended for general guidance only and no representation is made by the NTA as to the accuracy, completeness, sufficiency or otherwise of this information or any part of it. Any liabilities are hereby expressly disclaimed.</p>		<table border="1"> <thead> <tr> <th>Rev</th> <th>Date</th> <th>Drn</th> <th>Chk'd</th> <th>App'd</th> <th>Description</th> </tr> </thead> <tbody> <tr> <td>M01</td> <td>MAR 2023</td> <td>DS</td> <td>EOC</td> <td>SMG</td> <td>ISSUE FOR PHASE 4: PLANNING</td> </tr> </tbody> </table>	Rev	Date	Drn	Chk'd	App'd	Description	M01	MAR 2023	DS	EOC	SMG	ISSUE FOR PHASE 4: PLANNING	<p>Client</p> <p>Údarás Náisiúnta Iompair National Transport Authority</p>	<p>Engineering Designer</p>	<p>Programme Title</p> <p><b>BUSCONNECTS DUBLIN</b> <b>CORE BUS CORRIDORS INFRASTRUCTURE WORKS</b></p>
		Rev	Date	Drn	Chk'd	App'd	Description										
M01	MAR 2023	DS	EOC	SMG	ISSUE FOR PHASE 4: PLANNING												
<p>Date</p> <p>MAR 2023</p> <p>Programme Code</p> <p>BCIDD</p>	<p>Scale</p> <p>1:500 @ A1 1:1000 @ A3</p> <p>Originator Code</p> <p>ROT</p>	<p>Drawn</p> <p>DS</p> <p>Checked</p> <p>EOC</p> <p>Approved</p> <p>SMG</p>	<p>Drawing Title</p> <p>RINGSEND TO CITY CENTRE CORE BUS CORRIDOR SCHEME GNI ASSET ALTERATIONS</p>	<p>Drawing File Name</p> <p>BCIDD-ROT-UTL_UG-0016_XX_00-DR-CU-0003</p>	<p>Sheet Number</p> <p>03 of 12</p>	<p>Status</p> <p>A</p>	<p>Rev</p> <p>M01</p>										

DO NOT SCALE USE FIGURED DIMENSIONS ONLY

\\nodub\p1\j2019\19117-02\_WIP\08 MODELS\01 CAD\01 PLANNING\16 RINGSEND\BCIDD-ROT-UTL\_UG-0016\_XX\_00-DR-CU-0001.dwg



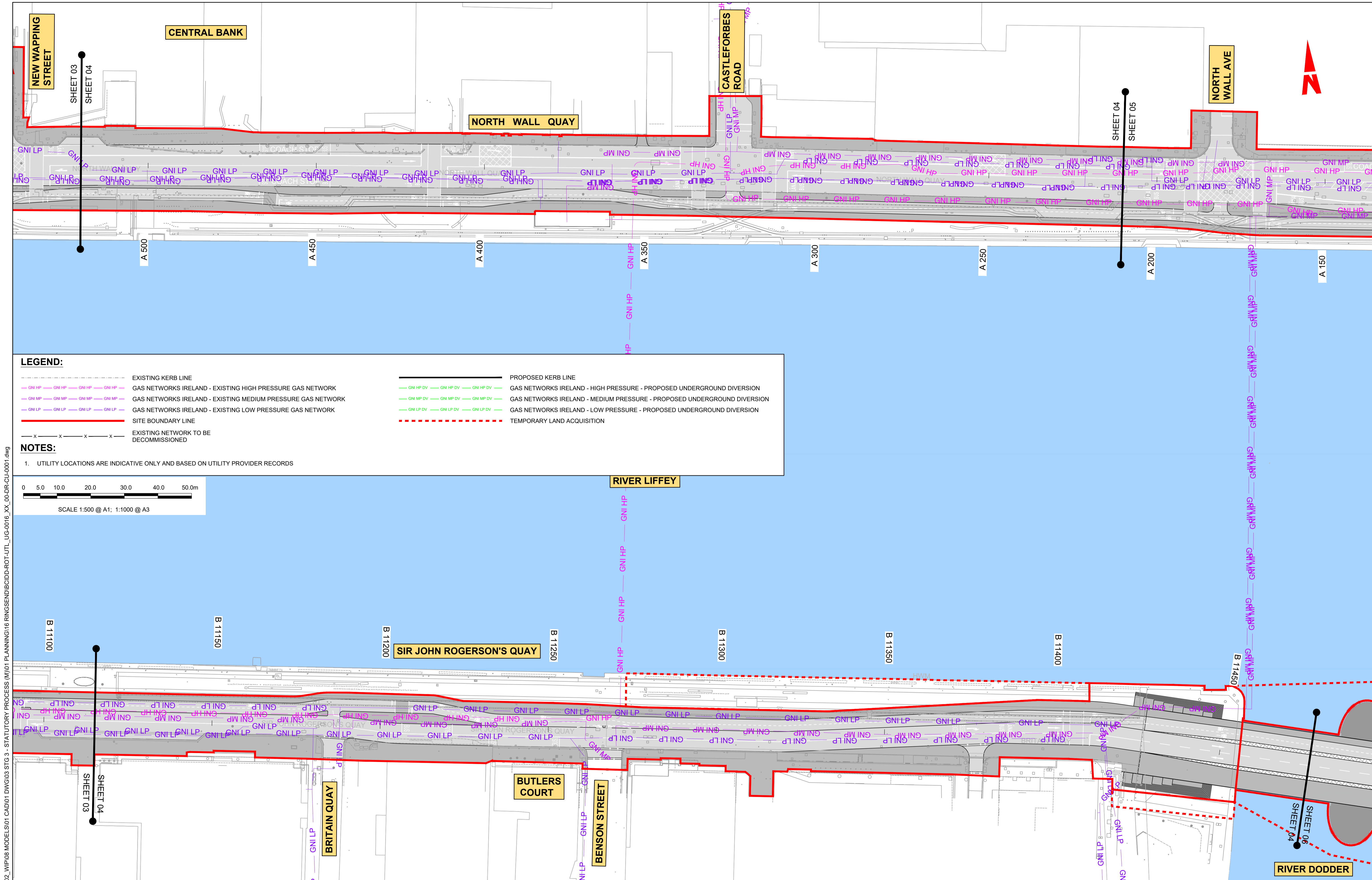

**LEGEND:**

- EXISTING KERB LINE
- PROPOSED KERB LINE
- GAS NETWORKS IRELAND - EXISTING HIGH PRESSURE GAS NETWORK
- GAS NETWORKS IRELAND - HIGH PRESSURE - PROPOSED UNDERGROUND DIVERSION
- GAS NETWORKS IRELAND - EXISTING MEDIUM PRESSURE GAS NETWORK
- GAS NETWORKS IRELAND - MEDIUM PRESSURE - PROPOSED UNDERGROUND DIVERSION
- GAS NETWORKS IRELAND - EXISTING LOW PRESSURE GAS NETWORK
- GAS NETWORKS IRELAND - LOW PRESSURE - PROPOSED UNDERGROUND DIVERSION
- SITE BOUNDARY LINE
- EXISTING NETWORK TO BE DECOMMISSIONED
- TEMPORARY LAND ACQUISITION

**NOTES:**

- UTILITY LOCATIONS ARE INDICATIVE ONLY AND BASED ON UTILITY PROVIDER RECORDS

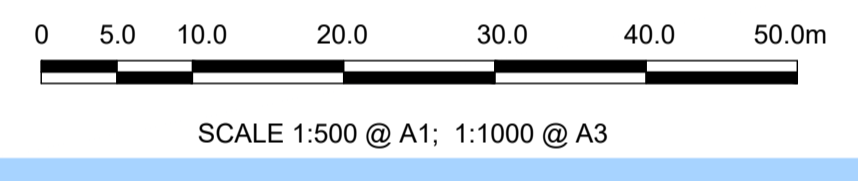

\\nodubhp1u20191917117-02\_WIP008 MODELS01 CAD01 DWG003 STG 3 - STATUTORY PROCESS (M)01 PLANNING16 RINGSEND/BCIDD-ROT-UTL\_UG-0016\_XX\_00-DR-CU-0001.dwg

<p><b>Disclaimer</b></p> <p>a. © National Transport Authority (NTA) 2022. This drawing is confidential and the copyright in it is owned by NTA. This drawing must not be either loaned, copied or otherwise reproduced in whole or in part or used for any purpose without the prior permission of NTA.</p> <p>b. This drawing is to be used for the design element identified in the titlebox. Other information shown is to be considered indicative only. The drawing is to be read in conjunction with all other relevant design drawings.</p> <p>c. O.S. data used for plans are printed under © Ordnance Survey Ireland Government of Ireland. All rights reserved. Licence Number 2022/O.S. NMA_180 National Transport Authority. All elevations are in metres and relate to OSI Geoid Model (OSGM15) Malin Head. All Co-ordinates are in Irish Transverse Mercator Grid (ITM) as defined by OSI active local GPS station.</p> <p>d. Information concerning the position of apparatus shown on this drawing is based on drawings supplied by the utility owners and/or the utility works contractor, whilst every care has been taken in the preparation of this drawing, positions should be taken as approximate and are intended for general guidance only and no representation is made by the NTA as to the accuracy, completeness, sufficiency or otherwise of this drawing and the position of the apparatus. The information contained herein does not purport to be comprehensive or final as the apparatus is subject to being altered and/or superseded. Recipients should not rely on this information. Any liabilities are hereby expressly disclaimed.</p> <p>e. The information contained herein has been provided by the NTA but does not purport to be comprehensive or final. Recipients should not rely on the information. Neither the NTA nor any of its directors, officers, employees, agents, stakeholders or advisers make any representation or warranty as to, or accept any liability or responsibility in relation to, the adequacy, accuracy, reasonableness or completeness of the information provided as part of this document or any matter on which the information is based (including but not limited to loss or damage arising as a result of reliance by recipients on the information or any part of it). Any liabilities are hereby expressly disclaimed.</p>		<table border="1"> <thead> <tr> <th>Rev</th> <th>Date</th> <th>Drn</th> <th>Chk'd</th> <th>App'd</th> <th>Description</th> </tr> </thead> <tbody> <tr> <td>M01</td> <td>MAR 2023</td> <td>DS</td> <td>EOC</td> <td>SMG</td> <td>ISSUE FOR PHASE 4: PLANNING</td> </tr> </tbody> </table>	Rev	Date	Drn	Chk'd	App'd	Description	M01	MAR 2023	DS	EOC	SMG	ISSUE FOR PHASE 4: PLANNING	<p>Client</p> <p>Údarás Náisiúnta Iompair National Transport Authority</p>	<p>Engineering Designer</p> <p>TYPSA</p>	<p>Programme Title</p> <p><b>BUSCONNECTS DUBLIN</b> <b>CORE BUS CORRIDORS INFRASTRUCTURE WORKS</b></p>
		Rev	Date	Drn	Chk'd	App'd	Description										
M01	MAR 2023	DS	EOC	SMG	ISSUE FOR PHASE 4: PLANNING												
<p>Date</p> <p>MAR 2023</p> <p>Programme Code</p> <p>BCIDD</p>	<p>Scale</p> <p>1:500 @ A1 1:1000 @ A3</p> <p>Originator Code</p> <p>ROT</p>	<p>Drawn</p> <p>DS</p> <p>Checked</p> <p>EOC</p> <p>Approved</p> <p>SMG</p>	<p>Drawing Title</p> <p>RINGSEND TO CITY CENTRE CORE BUS CORRIDOR SCHEME GNI ASSET ALTERATIONS</p>	<p>Drawing File Name</p> <p>BCIDD-ROT-UTL_UG-0016_XX_00-DR-CU-0004</p>	<p>Sheet Number</p> <p>04 of 12</p>	<p>Status</p> <p>A</p>	<p>Rev</p> <p>M01</p>										

DO NOT SCALE USE FIGURED DIMENSIONS ONLY



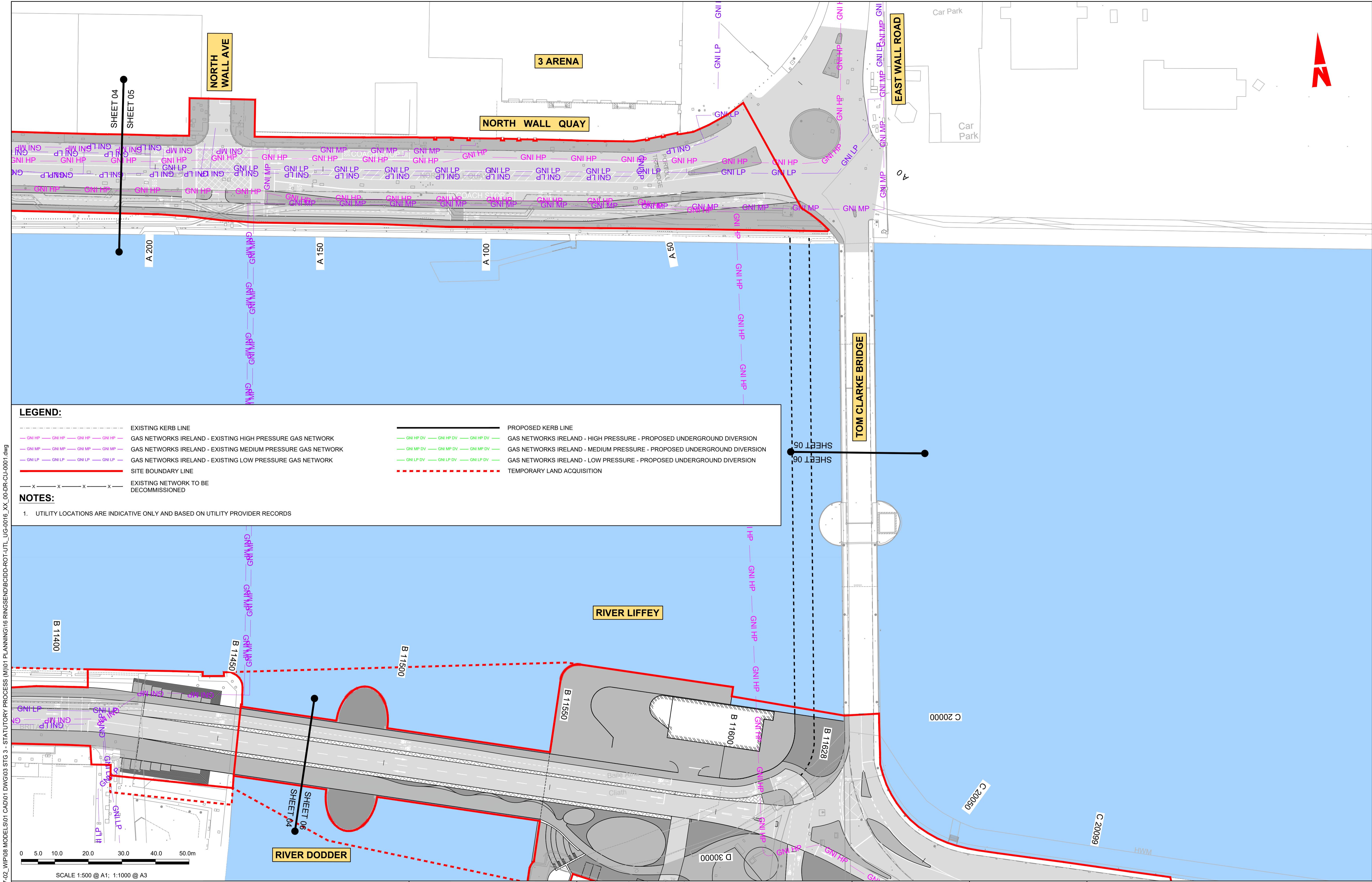

**LEGEND:**

- EXISTING KERB LINE
- GAS NETWORKS IRELAND - EXISTING HIGH PRESSURE GAS NETWORK
- GAS NETWORKS IRELAND - EXISTING MEDIUM PRESSURE GAS NETWORK
- GAS NETWORKS IRELAND - EXISTING LOW PRESSURE GAS NETWORK
- SITE BOUNDARY LINE
- EXISTING NETWORK TO BE DECOMMISSIONED
- PROPOSED KERB LINE
- GAS NETWORKS IRELAND - HIGH PRESSURE - PROPOSED UNDERGROUND DIVERSION
- GAS NETWORKS IRELAND - MEDIUM PRESSURE - PROPOSED UNDERGROUND DIVERSION
- GAS NETWORKS IRELAND - LOW PRESSURE - PROPOSED UNDERGROUND DIVERSION
- TEMPORARY LAND ACQUISITION

**NOTES:**

- UTILITY LOCATIONS ARE INDICATIVE ONLY AND BASED ON UTILITY PROVIDER RECORDS

W:\000000\19171717-02\_WIP\08 MODELS\01 CAD\01 DWG\03 STG 3 - STATUTORY PROCESS (M)\01 PLANNING\16 RINGSEND\BCIDD-ROT-UTL\_UG-0016\_XX\_00-DR-CU-0001.dwg

0 5.0 10.0 20.0 30.0 40.0 50.0m  
 SCALE 1:500 @ A1; 1:1000 @ A3

Transverse Mercator Grid (ITM) as defined by OSI active local GPS station.  
 Information concerning the position of apparatus shown on this drawing is based on drawings supplied by the utility owners and/or the utility works contractor, whilst every care has been taken in the preparation of this drawing, positions should be taken as approximate and are intended for general guidance only and no representation is made by the NTA as to the accuracy, completeness, sufficiency or otherwise of this drawing and the position of the apparatus. The information contained herein does not purport to be comprehensive or final as the apparatus is subject to being altered and/or superceded. Recipients should not rely on this information. Any liabilities are hereby expressly disclaimed.

Building Ireland's Future

Rev	Date	Drm	Chk'd	App'd	Description
M01	MAR 2023	DS	EOC	SMG	ISSUE FOR PHASE 4: PLANNING

**Client:** NTA  
 Údarás Náisiúnta Iompair  
 National Transport Authority

**Engineering Designer:** IROD  
 TYPSA

**Date:** MAR 2023  
**Scale:** 1:500 @ A1, 1:1000 @ A3  
**Programme Code:** BCIDD  
**Originator Code:** ROT

**Drawn:** DS  
**Checked:** EOC  
**Approved:** SMG

**Programme Title:** BUSCONNECTS DUBLIN  
 CORE BUS CORRIDORS INFRASTRUCTURE WORKS

**Drawing Title:** RINGSEND TO CITY CENTRE CORE BUS CORRIDOR SCHEME  
 GNI ASSET ALTERATIONS

**Drawing File Name:** BCIDD-ROT-UTL\_UG-0016\_XX\_00-DR-CU-0005  
**Sheet Number:** 05 of 12  
**Status:** A  
**Rev:** M01

DO NOT SCALE USE FIGURED DIMENSIONS ONLY



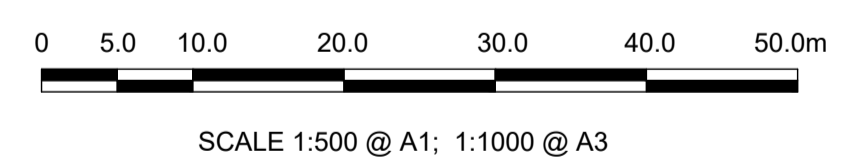
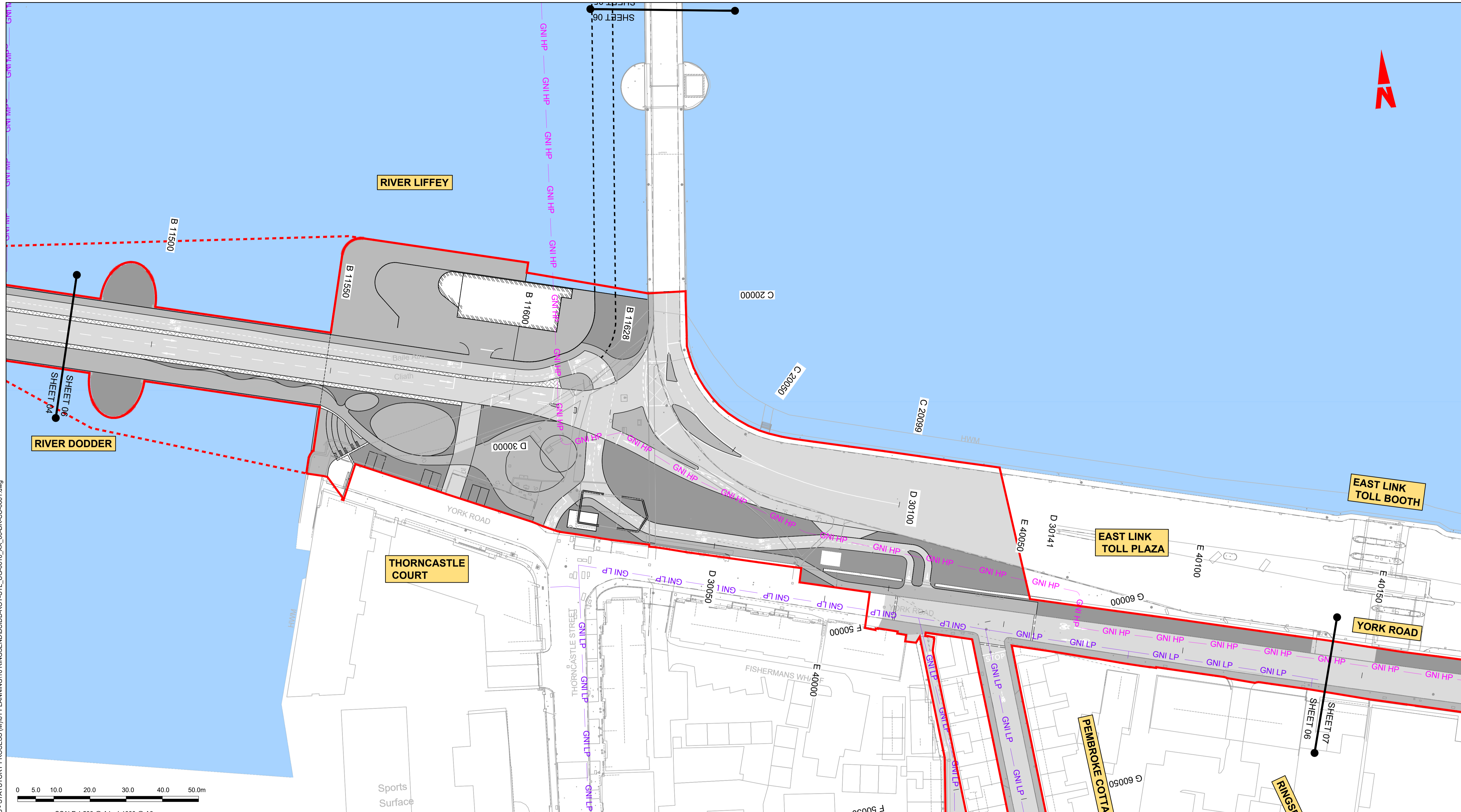

**LEGEND:**

	EXISTING KERB LINE		PROPOSED KERB LINE
	GAS NETWORKS IRELAND - EXISTING HIGH PRESSURE GAS NETWORK		GAS NETWORKS IRELAND - HIGH PRESSURE - PROPOSED UNDERGROUND DIVERSION
	GAS NETWORKS IRELAND - EXISTING MEDIUM PRESSURE GAS NETWORK		GAS NETWORKS IRELAND - MEDIUM PRESSURE - PROPOSED UNDERGROUND DIVERSION
	GAS NETWORKS IRELAND - EXISTING LOW PRESSURE GAS NETWORK		GAS NETWORKS IRELAND - LOW PRESSURE - PROPOSED UNDERGROUND DIVERSION
	SITE BOUNDARY LINE		TEMPORARY LAND ACQUISITION
	EXISTING NETWORK TO BE DECOMMISSIONED		

**NOTES:**

- UTILITY LOCATIONS ARE INDICATIVE ONLY AND BASED ON UTILITY PROVIDER RECORDS

**Disclaimer**

a. © National Transport Authority (NTA) 2022. This drawing is confidential and the copyright in it is owned by NTA. This drawing must not be either loaned, copied or otherwise reproduced in whole or in part or used for any purpose without the prior permission of NTA.

b. This drawing is to be used for the design element identified in the titleblock. Other information shown is to be considered indicative only. The drawing is to be read in conjunction with all other relevant design drawings.

c. O.S. data used for plans are printed under © Ordnance Survey Ireland Government of Ireland. All rights reserved. Licence Number 2022/OSI\_NMA\_180 National Transport Authority. All elevations are in metres and relate to OSI Geoid Model (OSGM15) Mean Head. All Co-ordinates are in Irish Transverse Mercator Grid (ITM) as defined by OSI active local GPS station.

d. Information concerning the position of apparatus shown on this drawing is based on drawings supplied by the utility owners and/or the utility works contractor, whilst every care has been taken in the preparation of this drawing, positions should be taken as approximate and are intended for general guidance only and no representation is made by the NTA as to the accuracy, completeness, sufficiency or otherwise of this drawing and the position of the apparatus. The information contained herein does not purport to be comprehensive or final as the apparatus is subject to being altered and/or superceded. Recipients should not rely on this information. Any liabilities are hereby expressly disclaimed.

e. The information contained herein has been provided by the NTA but does not purport to be comprehensive or final. Recipients should not rely on the information. Neither the NTA nor any of its directors, officers, employees, agents, stakeholders or advisers make any representation or warranty as to, or accept any liability or responsibility in relation to, the adequacy, accuracy, reasonableness or completeness of the information provided as part of this document or any matter on which the information is based (including but not limited to loss or damage arising as a result of reliance by recipients on the information or any part of it). Any liabilities are hereby expressly disclaimed.



Rev	Date	Drn	Chk'd	App'd	Description
M01	MAR 2023	DS	EOC	SMG	ISSUE FOR PHASE 4: PLANNING

Client: **NTA**  
Údarás Náisiúnta Iompair  
National Transport Authority

Engineering Designer: **PROD**  
TYPSA

Date: MAR 2023  
Scale: 1:500 @ A1  
1:1000 @ A3

Programme Code: BCIDD  
Originator Code: ROT

Drawn: DS  
Checked: EOC  
Approved: SMG

Programme Title: <b>BUSCONNECTS DUBLIN CORE BUS CORRIDORS INFRASTRUCTURE WORKS</b>			
Drawing Title: <b>RINGSEND TO CITY CENTRE CORE BUS CORRIDOR SCHEME GNI ASSET ALTERATIONS</b>			
Drawing File Name: BCIDD-ROT-UTL_UG-0016_XX_00-DR-CU-0006	Sheet Number: 06 of 12	Status: A	Rev: M01

DO NOT SCALE USE FIGURED DIMENSIONS ONLY

\\produbp1u201919171717-02\_WIP08 MODELS01 CAD01 DWG003 STG 3 - STATUTORY PROCESS (M)01 PLANNING16 RINGSEND/BCIDD-ROT-UTL\_UG-0016\_XX\_00-DR-CU-0001.dwg



**LEGEND:**

	EXISTING KERB LINE		PROPOSED KERB LINE
	GAS NETWORKS IRELAND - EXISTING HIGH PRESSURE GAS NETWORK		GAS NETWORKS IRELAND - HIGH PRESSURE - PROPOSED UNDERGROUND DIVERSION
	GAS NETWORKS IRELAND - EXISTING MEDIUM PRESSURE GAS NETWORK		GAS NETWORKS IRELAND - MEDIUM PRESSURE - PROPOSED UNDERGROUND DIVERSION
	GAS NETWORKS IRELAND - EXISTING LOW PRESSURE GAS NETWORK		GAS NETWORKS IRELAND - LOW PRESSURE - PROPOSED UNDERGROUND DIVERSION
	SITE BOUNDARY LINE		TEMPORARY LAND ACQUISITION
	EXISTING NETWORK TO BE DECOMMISSIONED		

**NOTES:**

- UTILITY LOCATIONS ARE INDICATIVE ONLY AND BASED ON UTILITY PROVIDER RECORDS

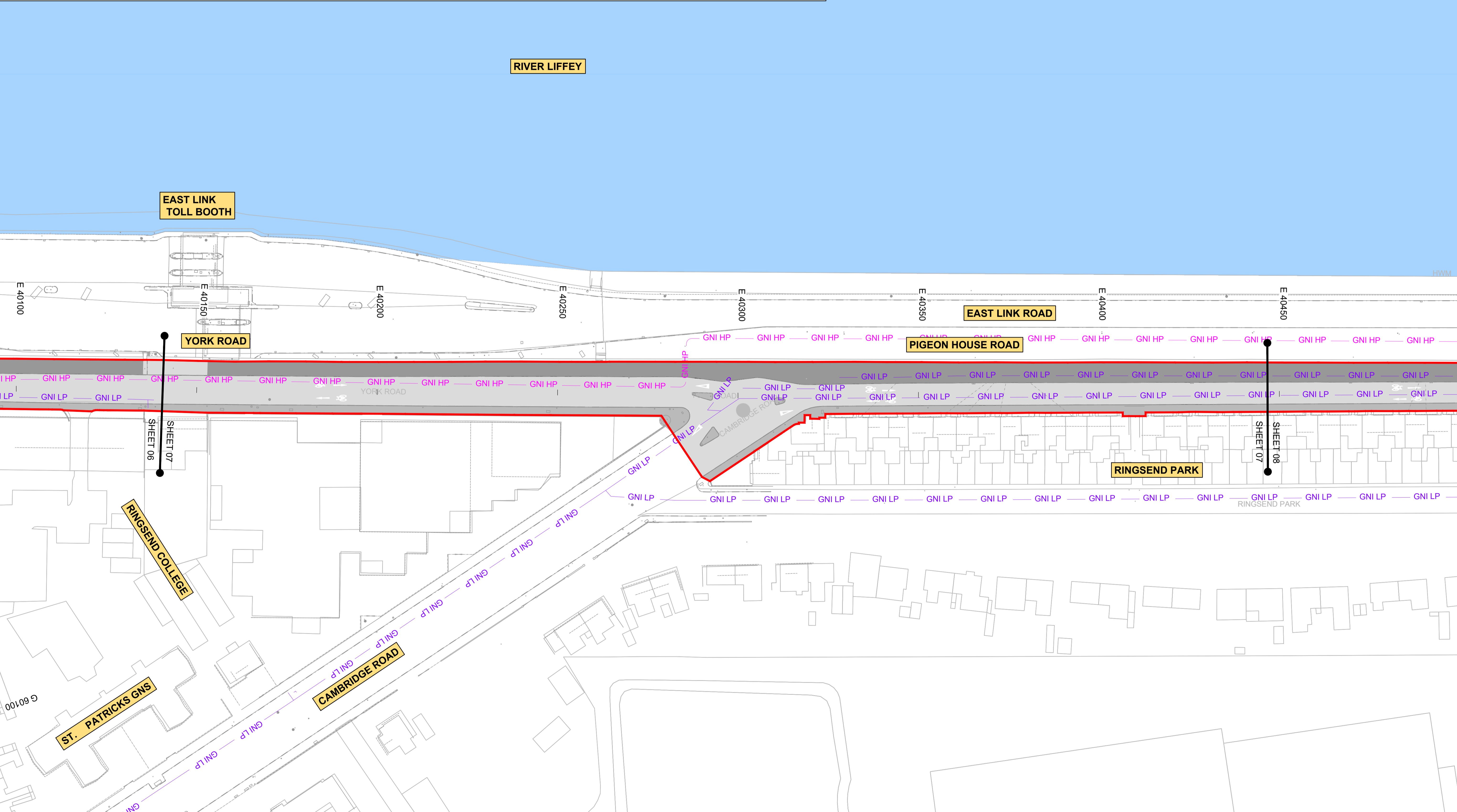
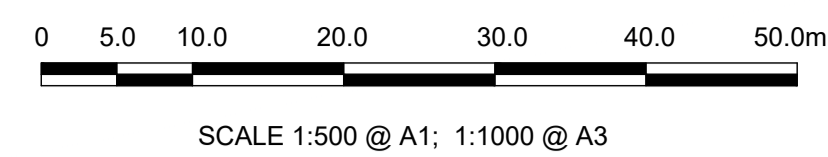

\\vodubp1u2019191717117-02\_WIP08 MODELS01 CAD01 DWG03 STG 3 - STATUTORY PROCESS (M)01 PLANNING16 RINGSEND/BCIDD-ROT-UTL\_UG-0016\_XX\_00-DR-CU-0001.dwg

<p><small>Disclaimer</small></p> <p>a. © National Transport Authority (NTA) 2022. This drawing is confidential and the copyright in it is owned by NTA. This drawing must not be either loaned, copied or otherwise reproduced in whole or in part or used for any purpose without the prior permission of NTA.</p> <p>b. This drawing is to be used for the design element identified in the titleblock. Other information shown is to be considered indicative only. The drawing is to be read in conjunction with all other relevant design drawings.</p> <p>c. O.S. data used for plans are printed under © Ordnance Survey Ireland Government of Ireland. All rights reserved. Licence Number 2022/OSI_NMA_180 National Transport Authority. All elevations are in metres and relate to OSI Geoid Model (OSGM15) Malin Head. All Co-ordinates are in Irish Transverse Mercator Grid (ITM) as defined by OSI active local GPS station.</p> <p>d. Information concerning the position of apparatus shown on this drawing is based on drawings supplied by the utility owners and/or the utility works contractor, whilst every care has been taken in the preparation of this drawing, positions should be taken as approximate and are intended for general guidance only and no representation is made by the NTA as to the accuracy, completeness, sufficiency or otherwise of this drawing and the position of the apparatus. The information contained herein does not purport to be comprehensive or final as the apparatus is subject to being altered and/or superceded. Recipients should not rely on this information. Any liabilities are hereby expressly disclaimed.</p> <p>e. The information contained herein has been provided by the NTA but does not purport to be comprehensive or final. Recipients should not rely on the information. Neither the NTA nor any of its directors, officers, employees, agents, stakeholders or advisers make any representation or warranty as to, or accept any liability or responsibility in relation to, the adequacy, accuracy, reasonableness or completeness of the information provided as part of this document or any matter on which the information is based (including but not limited to loss or damage arising as a result of reliance by recipients on the information or any part of it). Any liabilities are hereby expressly disclaimed.</p>				<table border="1"> <thead> <tr> <th>Rev</th> <th>Date</th> <th>Drn</th> <th>Chk'd</th> <th>App'd</th> <th>Description</th> </tr> </thead> <tbody> <tr> <td>M01</td> <td>MAR 2023</td> <td>DS</td> <td>EOC</td> <td>SMG</td> <td>ISSUE FOR PHASE 4: PLANNING</td> </tr> </tbody> </table>	Rev	Date	Drn	Chk'd	App'd	Description	M01	MAR 2023	DS	EOC	SMG	ISSUE FOR PHASE 4: PLANNING	<p>Client</p> <p>Údarás Náisiúnta Iompair National Transport Authority</p>	<p>Engineering Designer</p>	<p>Programme Title</p> <p><b>BUSCONNECTS DUBLIN</b> <b>CORE BUS CORRIDORS INFRASTRUCTURE WORKS</b></p>
Rev	Date	Drn	Chk'd	App'd	Description														
M01	MAR 2023	DS	EOC	SMG	ISSUE FOR PHASE 4: PLANNING														
<p>Date: MAR 2023   Scale: 1:500 @ A1, 1:1000 @ A3   Drawn: DS   Checked: EOC   Approved: SMG</p>						<p>Drawing Title</p> <p>RINGSEND TO CITY CENTRE CORE BUS CORRIDOR SCHEME GNI ASSET ALTERATIONS</p>													
<p>Programme Code: BCIDD   Originator Code: ROT   QMS Code:</p>						<p>Drawing File Name: BCIDD-ROT-UTL_UG-0016_XX_00-DR-CU-0007   Sheet Number: 07 of 12   Status: A   Rev: M01</p>													

DO NOT SCALE USE FIGURED DIMENSIONS ONLY



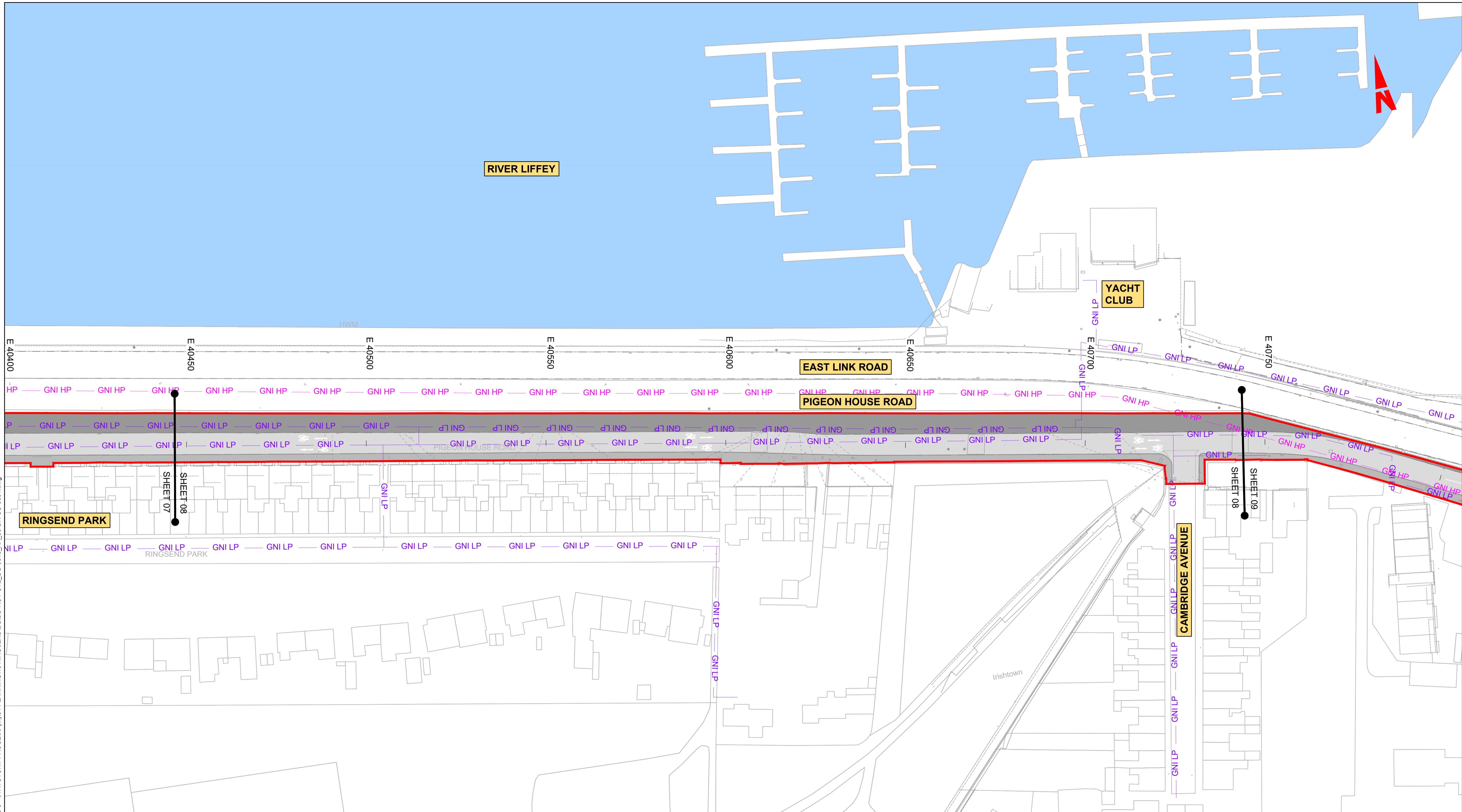

**LEGEND:**

- EXISTING KERB LINE
- PROPOSED KERB LINE
- GAS NETWORKS IRELAND - EXISTING HIGH PRESSURE GAS NETWORK
- GAS NETWORKS IRELAND - HIGH PRESSURE - PROPOSED UNDERGROUND DIVERSION
- GAS NETWORKS IRELAND - EXISTING MEDIUM PRESSURE GAS NETWORK
- GAS NETWORKS IRELAND - MEDIUM PRESSURE - PROPOSED UNDERGROUND DIVERSION
- GAS NETWORKS IRELAND - EXISTING LOW PRESSURE GAS NETWORK
- GAS NETWORKS IRELAND - LOW PRESSURE - PROPOSED UNDERGROUND DIVERSION
- SITE BOUNDARY LINE
- TEMPORARY LAND ACQUISITION
- EXISTING NETWORK TO BE DECOMMISSIONED

**NOTES:**

- UTILITY LOCATIONS ARE INDICATIVE ONLY AND BASED ON UTILITY PROVIDER RECORDS

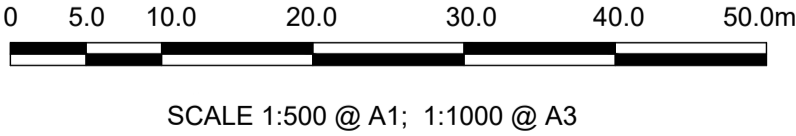

**Disclaimer**

a. © National Transport Authority (NTA) 2022. This drawing is confidential and the copyright in it is owned by NTA. This drawing must not be either loaned, copied or otherwise reproduced in whole or in part or used for any purpose without the prior permission of NTA.

b. This drawing is to be used for the design element identified in the titlebox. Other information shown is to be considered indicative only. The drawing is to be read in conjunction with all other relevant design drawings.

c. O.S. data used for plans are printed under © Ordnance Survey Ireland Government of Ireland. All rights reserved. Licence Number 2022/OSI\_NMA\_180 National Transport Authority. All elevations are in metres and relate to OSI Geoid Model (OSGM15) Mean Head. All Co-ordinates are in Irish Transverse Mercator Grid (ITM) as defined by OSI active local GPS station.

d. Information concerning the position of apparatus shown on this drawing is based on drawings supplied by the utility owners and/or the utility works contractor, whilst every care has been taken in the preparation of this drawing, positions should be taken as approximate and are intended for general guidance only and no representation is made by the NTA as to the accuracy, completeness, sufficiency or otherwise of this drawing and the position of the apparatus. The information contained herein does not purport to be comprehensive or final as the apparatus is subject to being altered and/or superseded. Recipients should not rely on this information. Any liabilities are hereby expressly disclaimed.

e. The information contained herein has been provided by the NTA but does not purport to be comprehensive or final. Recipients should not rely on the information. Neither the NTA nor any of its directors, officers, employees, agents, stakeholders or advisers make any representation or warranty as to, or accept any liability or responsibility in relation to, the adequacy, accuracy, reasonableness or completeness of the information provided as part of this document or any matter on which the information is based (including but not limited to loss or damage arising as a result of reliance by recipients on the information or any part of it). Any liabilities are hereby expressly disclaimed.



Rev	Date	Drn	Chk'd	App'd	Description
M01	MAR 2023	DS	EOC	SMG	ISSUE FOR PHASE 4: PLANNING

Client

Date: MAR 2023  
Scale: 1:500 @ A1, 1:1000 @ A3

Engineering Designer

Drawn: DS  
Checked: EOC  
Approved: SMG

Programme Title <b>BUSCONNECTS DUBLIN CORE BUS CORRIDORS INFRASTRUCTURE WORKS</b>			
Drawing Title RINGSEND TO CITY CENTRE CORE BUS CORRIDOR SCHEME GNI ASSET ALTERATIONS			
Drawing File Name BCIDD-ROT-UTL_UG-0016_XX_00-DR-CU-0008	Sheet Number 08 of 12	Status A	Rev M01

DO NOT SCALE USE FIGURED DIMENSIONS ONLY

\\vodubp1u20191917119117-02\_WIP08 MODELS01 CAD01 DWG003 STG 3 - STATUTORY PROCESS (M)01 PLANNING16 RINGSENDBCIDD-ROT-UTL\_UG-0016\_XX\_00-DR-CU-0001.dwg



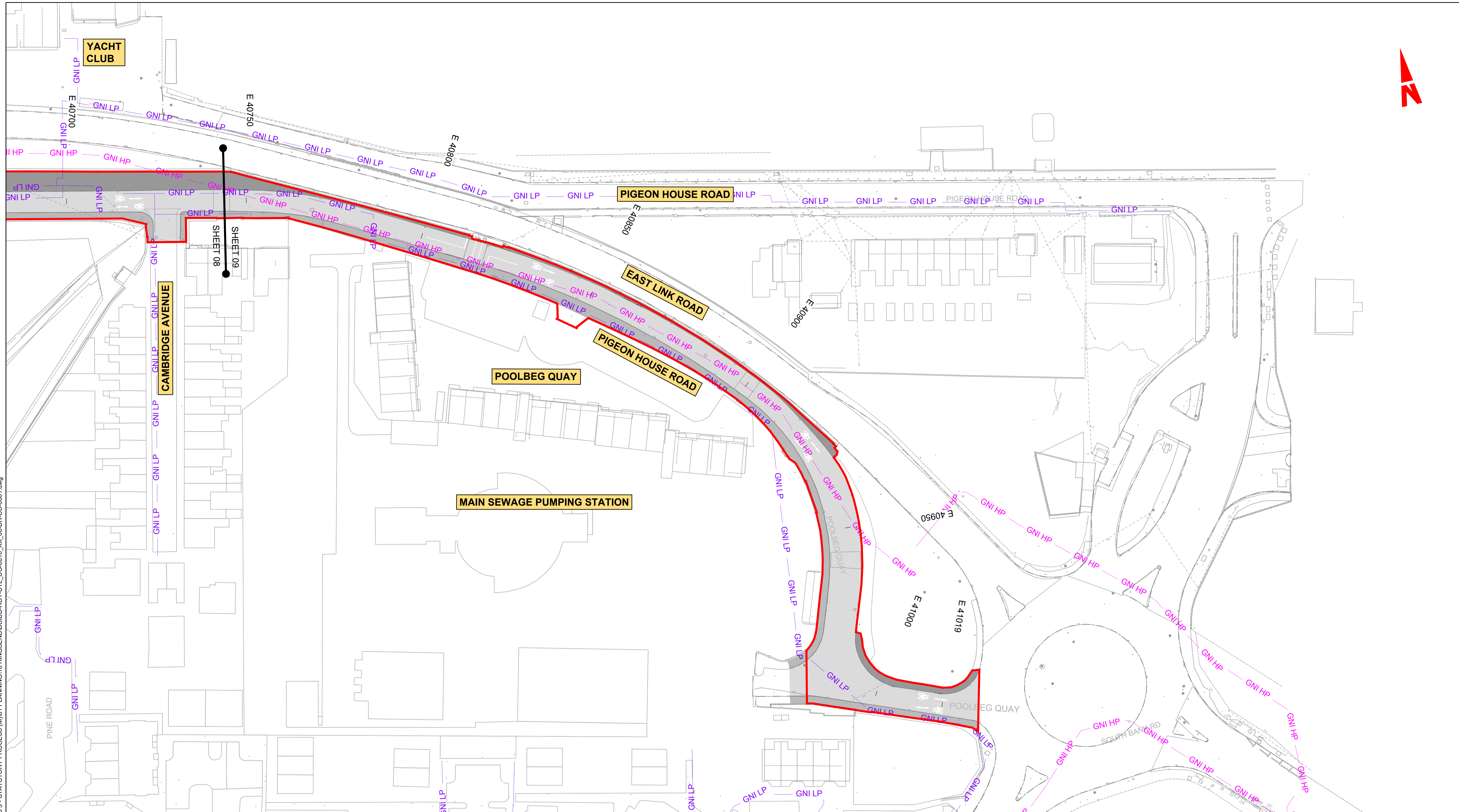

**LEGEND:**

- EXISTING KERB LINE
- PROPOSED KERB LINE
- GAS NETWORKS IRELAND - EXISTING HIGH PRESSURE GAS NETWORK
- GAS NETWORKS IRELAND - HIGH PRESSURE - PROPOSED UNDERGROUND DIVERSION
- GAS NETWORKS IRELAND - EXISTING MEDIUM PRESSURE GAS NETWORK
- GAS NETWORKS IRELAND - MEDIUM PRESSURE - PROPOSED UNDERGROUND DIVERSION
- GAS NETWORKS IRELAND - EXISTING LOW PRESSURE GAS NETWORK
- GAS NETWORKS IRELAND - LOW PRESSURE - PROPOSED UNDERGROUND DIVERSION
- SITE BOUNDARY LINE
- TEMPORARY LAND ACQUISITION
- EXISTING NETWORK TO BE DECOMMISSIONED

**NOTES:**

- UTILITY LOCATIONS ARE INDICATIVE ONLY AND BASED ON UTILITY PROVIDER RECORDS

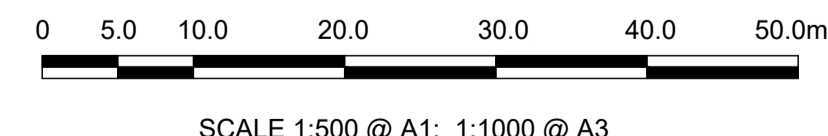

<p><small>Disclaimer</small></p> <p>a. © National Transport Authority (NTA) 2022. This drawing is confidential and the copyright in it is owned by NTA. This drawing must not be either loaned, copied or otherwise reproduced in whole or in part or used for any purpose without the prior permission of NTA.</p> <p>b. This drawing is to be used for the design element identified in the titlebox. Other information shown is to be considered indicative only. The drawing is to be read in conjunction with all other relevant design drawings.</p> <p>c. O.S. data used for plans are printed under © Ordnance Survey Ireland Government of Ireland. All rights reserved. Licence Number 2022/OSI_NMA_180 National Transport Authority. All elevations are in metres and relate to OSI Geoid Model (OSGM15) Mean Head. All Co-ordinates are in Irish Transverse Mercator Grid (ITM) as defined by OSI active local GPS station.</p> <p>d. Information concerning the position of apparatus shown on this drawing is based on drawings supplied by the utility owners and/or the utility works contractor, whilst every care has been taken in the preparation of this drawing, positions should be taken as approximate and are intended for general guidance only and no representation is made by the NTA as to the accuracy, completeness, sufficiency or otherwise of this drawing and the position of the apparatus. The information contained herein does not purport to be comprehensive or final as the apparatus is subject to being altered and/or superceded. Recipients should not rely on this information. Any liabilities are hereby expressly disclaimed.</p> <p>e. The information contained herein has been provided by the NTA but does not purport to be comprehensive or final. Recipients should not rely on the information. Neither the NTA nor any of its directors, officers, employees, agents, stakeholders or advisers make any representation or warranty as to, or accept any liability or responsibility in relation to, the adequacy, accuracy, reasonableness or completeness of the information provided as part of this document or any matter on which the information is based (including but not limited to loss or damage arising as a result of reliance by recipients on the information or any part of it). Any liabilities are hereby expressly disclaimed.</p>		Rev	Date	Dwn	Chk'd	App'd	Description	<p>Client</p> <p>Údarás Náisiúnta Iompair National Transport Authority</p>	Engineering Designer			<p>Programme Title</p> <p><b>BUSCONNECTS DUBLIN</b> <b>CORE BUS CORRIDORS INFRASTRUCTURE WORKS</b></p>			
		M01	MAR 2023	DS	EOC	SMG	ISSUE FOR PHASE 4: PLANNING		<p>Údarás Náisiúnta Iompair National Transport Authority</p>		<p>Drawn</p> <p>DS</p>	<p>Checked</p> <p>EOC</p>	<p>Approved</p> <p>SMG</p>	<p>Drawing Title</p> <p>RINGSEND TO CITY CENTRE CORE BUS CORRIDOR SCHEME GNI ASSET ALTERATIONS</p>	<p>Drawing File Name</p> <p>BCIDD-ROT-UTL_UG-0016_XX_00-DR-CU-0009</p>

DO NOT SCALE USE FIGURED DIMENSIONS ONLY

\\produbhp1u2019191717117-02\_WIP08 MODELS01 CAD01 DWG03 STG 3 - STATUTORY PROCESS (M)01 PLANNING16 RINGSEND/BCIDD-ROT-UTL\_UG-0016\_XX\_00-DR-CU-0001.dwg



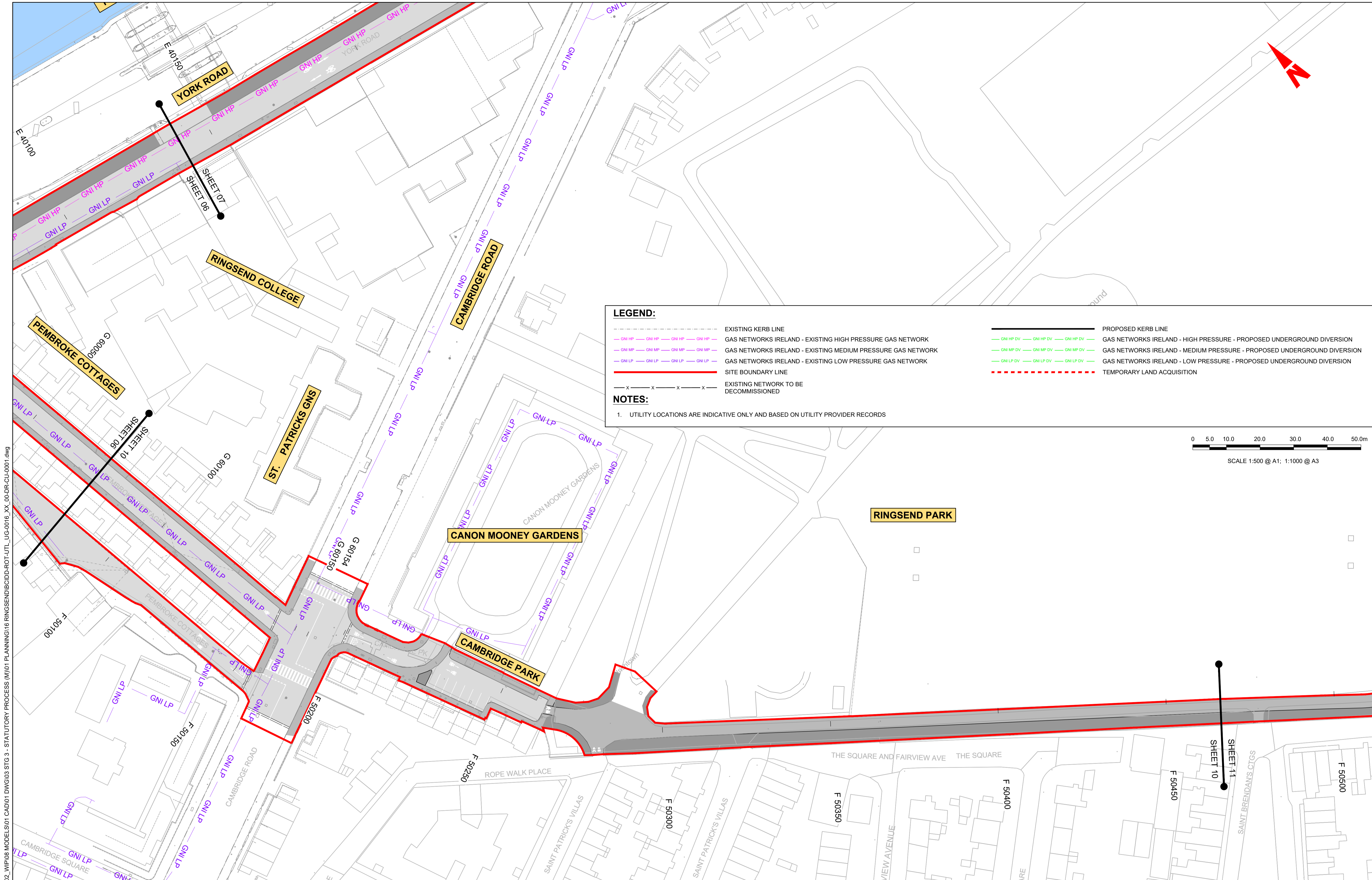

**LEGEND:**

- EXISTING KERB LINE
- GAS NETWORKS IRELAND - EXISTING HIGH PRESSURE GAS NETWORK
- GAS NETWORKS IRELAND - EXISTING MEDIUM PRESSURE GAS NETWORK
- GAS NETWORKS IRELAND - EXISTING LOW PRESSURE GAS NETWORK
- SITE BOUNDARY LINE
- EXISTING NETWORK TO BE DECOMMISSIONED
- PROPOSED KERB LINE
- GAS NETWORKS IRELAND - HIGH PRESSURE - PROPOSED UNDERGROUND DIVERSION
- GAS NETWORKS IRELAND - MEDIUM PRESSURE - PROPOSED UNDERGROUND DIVERSION
- GAS NETWORKS IRELAND - LOW PRESSURE - PROPOSED UNDERGROUND DIVERSION
- TEMPORARY LAND ACQUISITION

**NOTES:**

1. UTILITY LOCATIONS ARE INDICATIVE ONLY AND BASED ON UTILITY PROVIDER RECORDS

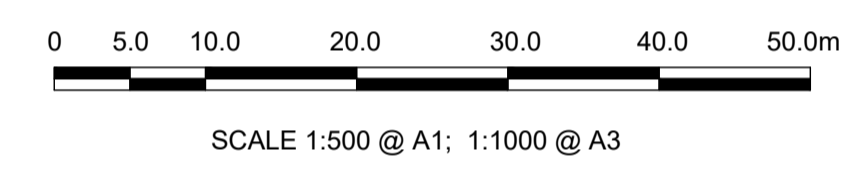

W:\000000\19171717-02\_WIP\08 MODELS\01 CAD\01 DWG\03 STG 3 - STATUTORY PROCESS (M)\01 PLANNING\16 RINGSEND\BCIDD-ROT-UTL\_UG-0016\_XX\_00-DR-CU-001.dwg

**Disclaimer**

a. © National Transport Authority (NTA) 2022. This drawing is confidential and the copyright in it is owned by NTA. This drawing must not be either loaned, copied or otherwise reproduced in whole or in part or used for any purpose without the prior permission of NTA.

b. This drawing is to be used for the design element identified in the title block. Other information shown is to be considered indicative only. The drawing is to be read in conjunction with all other relevant design drawings.

c. O.S. data used for plans are printed under © Ordnance Survey Ireland Government of Ireland. All rights reserved. Licence Number 2022/OSI\_NMA\_180 National Transport Authority. All elevations are in metres and relate to OSI Geoid Model (OSGM15) Mean Head. All Co-ordinates are in Irish Transverse Mercator Grid (ITM) as defined by OSI active local GPS station.

d. Information concerning the position of apparatus shown on this drawing is based on drawings supplied by the utility owners and/or the utility works contractor, whilst every care has been taken in the preparation of this drawing, positions should be taken as approximate and are intended for general guidance only and no representation is made by the NTA as to the accuracy, completeness, sufficiency or otherwise of this drawing and the position of the apparatus. The information contained herein does not purport to be comprehensive or final as the apparatus is subject to being altered and/or superseded. Recipients should not rely on this information. Any liabilities are hereby expressly disclaimed.

e. The information contained herein has been provided by the NTA but does not purport to be comprehensive or final. Recipients should not rely on the information. Neither the NTA nor any of its directors, officers, employees, agents, stakeholders or advisers make any representation or warranty as to, or accept any liability or responsibility in relation to, the adequacy, accuracy, reasonableness or completeness of the information provided as part of this document or any matter on which the information is based (including but not limited to loss or damage arising as a result of reliance by recipients on the information or any part of it). Any liabilities are hereby expressly disclaimed.



Rev	Date	Drn	Chk'd	App'd	Description
M01	MAR 2023	DS	EOC	SMG	ISSUE FOR PHASE 4: PLANNING

Client: **NTA**  
Údarás Náisiúnta Iompair  
National Transport Authority

Engineering Designer: **CIROD**  
TYPSA

Date: MAR 2023 | Scale: 1:500 @ A1, 1:1000 @ A3 | Drawn: DS | Checked: EOC | Approved: SMG

Programme Code: BCIDD | Originator Code: ROT | QMS Code:

Programme Title: <b>BUSCONNECTS DUBLIN CORE BUS CORRIDORS INFRASTRUCTURE WORKS</b>			
Drawing Title: RINGSEND TO CITY CENTRE CORE BUS CORRIDOR SCHEME GNI ASSET ALTERATIONS			
Drawing File Name: BCIDD-ROT-UTL_UG-0016_XX_00-DR-CU-0010	Sheet Number: 10 of 12	Status: A	Rev: M01

DO NOT SCALE USE FIGURED DIMENSIONS ONLY



**LEGEND:**

- EXISTING KERB LINE
- GAS NETWORKS IRELAND - EXISTING HIGH PRESSURE GAS NETWORK
- GAS NETWORKS IRELAND - EXISTING MEDIUM PRESSURE GAS NETWORK
- GAS NETWORKS IRELAND - EXISTING LOW PRESSURE GAS NETWORK
- SITE BOUNDARY LINE
- EXISTING NETWORK TO BE DECOMMISSIONED
- PROPOSED KERB LINE
- GAS NETWORKS IRELAND - HIGH PRESSURE - PROPOSED UNDERGROUND DIVERSION
- GAS NETWORKS IRELAND - MEDIUM PRESSURE - PROPOSED UNDERGROUND DIVERSION
- GAS NETWORKS IRELAND - LOW PRESSURE - PROPOSED UNDERGROUND DIVERSION
- TEMPORARY LAND ACQUISITION

**NOTES:**

1. UTILITY LOCATIONS ARE INDICATIVE ONLY AND BASED ON UTILITY PROVIDER RECORDS



SCALE 1:500 @ A1; 1:1000 @ A3

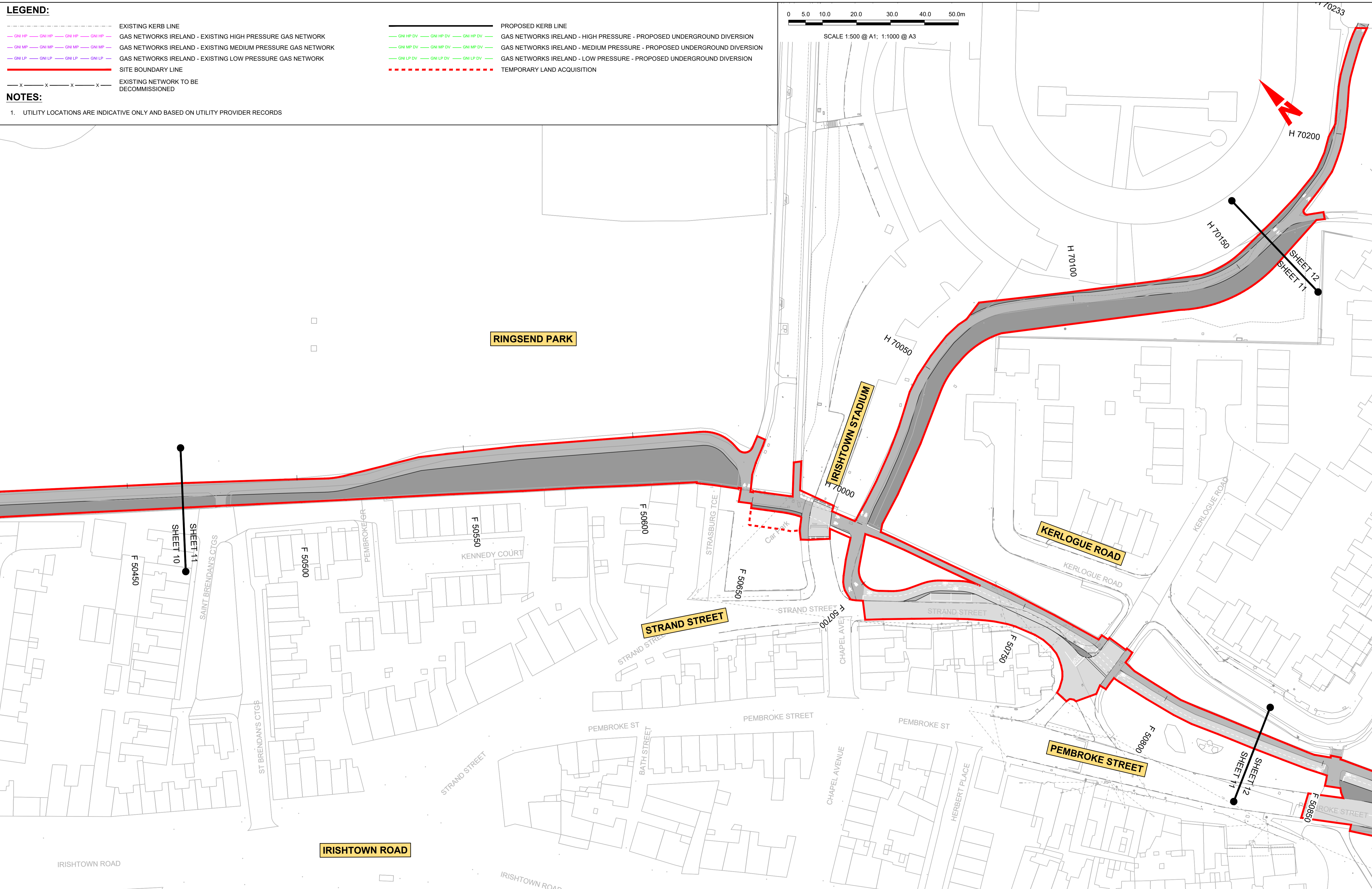

\\produbp1u2019191717117-02\_WIP08 MODELS01 CAD01 DWG03 STG 3 - STATUTORY PROCESS (M)01 PLANNING16 RINGSEND\BCIDD-ROT-UTL\_UG-0016\_XX\_00-DR-CU-0001.dwg

**Disclaimer**

a. © National Transport Authority (NTA) 2022. This drawing is confidential and the copyright in it is owned by NTA. This drawing must not be either loaned, copied or otherwise reproduced in whole or in part or used for any purpose without the prior permission of NTA.

b. This drawing is to be used for the design element identified in the titlebox. Other information shown is to be considered indicative only. The drawing is to be read in conjunction with all other relevant design drawings.

c. O.S. data used for plans are printed under © Ordnance Survey Ireland Government of Ireland. All rights reserved. Licence Number 2022/OSI\_NMA\_180 National Transport Authority. All elevations are in metres and relate to OSI Geoid Model (OSGM15) Mean Head. All Co-ordinates are in Irish Transverse Mercator Grid (ITM) as defined by OSI active local GPS station.

d. Information concerning the position of apparatus shown on this drawing is based on drawings supplied by the utility owners and/or the utility works contractor, whilst every care has been taken in the preparation of this drawing, positions should be taken as approximate and are intended for general guidance only and no representation is made by the NTA as to the accuracy, completeness, sufficiency or otherwise of this drawing and the position of the apparatus. The information contained herein does not purport to be comprehensive or final as the apparatus is subject to being altered and/or superceded. Recipients should not rely on this information. Any liabilities are hereby expressly disclaimed.

e. The information contained herein has been provided by the NTA but does not purport to be comprehensive or final. Recipients should not rely on the information. Neither the NTA nor any of its directors, officers, employees, agents, stakeholders or advisers make any representation or warranty as to, or accept any liability or responsibility in relation to, the adequacy, accuracy, reasonableness or completeness of the information provided as part of this document or any matter on which the information is based (including but not limited to loss or damage arising as a result of reliance by recipients on the information or any part of it). Any liabilities are hereby expressly disclaimed.



Rev	Date	Drn	Chk'd	App'd	Description
M01	MAR 2023	DS	EOC	SMG	ISSUE FOR PHASE 4: PLANNING

<b>NTA</b> Údarás Náisiúnta Iompair National Transport Authority		<b>Engineering Designer</b> <b>CIROD</b> TYPSA		
Date	Scale	Drawn	Checked	Approved
MAR 2023	1:500 @ A1 1:1000 @ A3	DS	EOC	SMG
Programme Code	Originator Code	QMS Code		
BCIDD	ROT			

<b>Programme Title</b> <b>BUSCONNECTS DUBLIN</b> <b>CORE BUS CORRIDORS INFRASTRUCTURE WORKS</b>			
<b>Drawing Title</b> RINGSEND TO CITY CENTRE CORE BUS CORRIDOR SCHEME GNI ASSET ALTERATIONS			
Drawing File Name	Sheet Number	Status	Rev
BCIDD-ROT-UTL_UG-0016_XX_00-DR-CU-0011	11 of 12	A	M01

DO NOT SCALE USE FIGURED DIMENSIONS ONLY



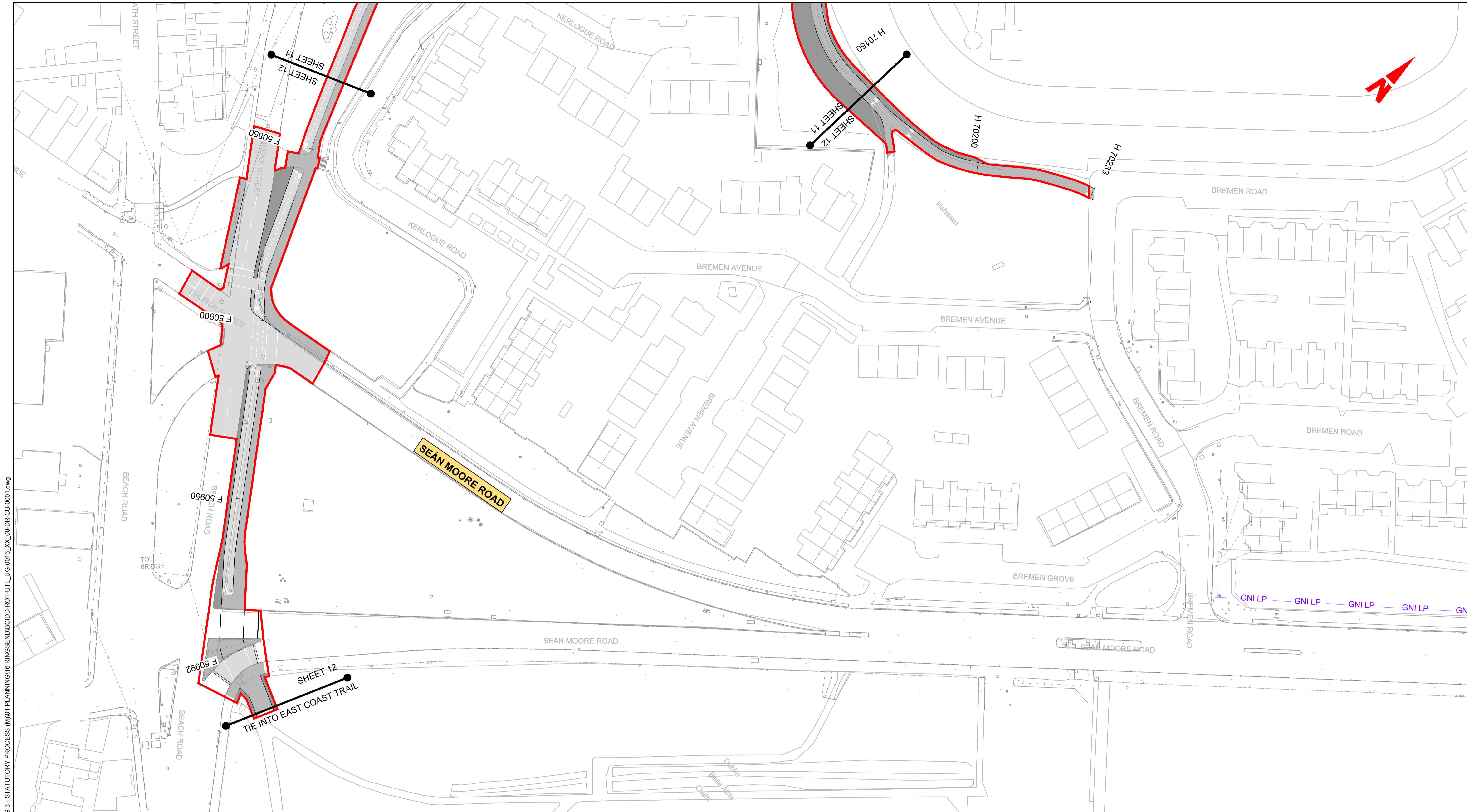

**LEGEND:**

	EXISTING KERB LINE		PROPOSED KERB LINE
	GAS NETWORKS IRELAND - EXISTING HIGH PRESSURE GAS NETWORK		GAS NETWORKS IRELAND - HIGH PRESSURE - PROPOSED UNDERGROUND DIVERSION
	GAS NETWORKS IRELAND - EXISTING MEDIUM PRESSURE GAS NETWORK		GAS NETWORKS IRELAND - MEDIUM PRESSURE - PROPOSED UNDERGROUND DIVERSION
	GAS NETWORKS IRELAND - EXISTING LOW PRESSURE GAS NETWORK		GAS NETWORKS IRELAND - LOW PRESSURE - PROPOSED UNDERGROUND DIVERSION
	SITE BOUNDARY LINE		TEMPORARY LAND ACQUISITION
	EXISTING NETWORK TO BE DECOMMISSIONED		

**NOTES:**

1. UTILITY LOCATIONS ARE INDICATIVE ONLY AND BASED ON UTILITY PROVIDER RECORDS

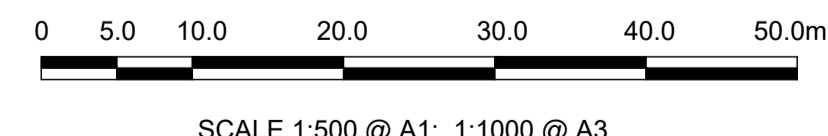

**Disclaimer**

a. © National Transport Authority (NTA) 2022. This drawing is confidential and the copyright in it is owned by NTA. This drawing must not be either loaned, copied or otherwise reproduced in whole or in part or used for any purpose without the prior permission of NTA.

b. This drawing is to be used for the design element identified in the titleblock. Other information shown is to be considered indicative only. The drawing is to be read in conjunction with all other relevant design drawings.

c. O.S. data used for plans are printed under © Ordnance Survey Ireland Government of Ireland. All rights reserved. Licence Number 2022/OSI\_NMA\_180 National Transport Authority. All elevations are in metres and relate to OSI Geoid Model (OSGM15) Mean Head. All Co-ordinates are in Irish Transverse Mercator Grid (ITM) as defined by OSI active local GPS station.

d. Information concerning the position of apparatus shown on this drawing is based on drawings supplied by the utility owners and/or the utility works contractor, whilst every care has been taken in the preparation of this drawing, positions should be taken as approximate and are intended for general guidance only and no representation is made by the NTA as to the accuracy, completeness, sufficiency or otherwise of this drawing and the position of the apparatus. The information contained herein does not purport to be comprehensive or final as the apparatus is subject to being altered and/or superseded. Recipients should not rely on this information. Any liabilities are hereby expressly disclaimed.

e. The information contained herein has been provided by the NTA but does not purport to be comprehensive or final. Recipients should not rely on the information. Neither the NTA nor any of its directors, officers, employees, agents, stakeholders or advisers make any representation or warranty as to, or accept any liability or responsibility in relation to, the adequacy, accuracy, reasonableness or completeness of the information provided as part of this document or any matter on which the information is based (including but not limited to loss or damage arising as a result of reliance by recipients on the information or any part of it). Any liabilities are hereby expressly disclaimed.



Rev	Date	Drn	Chk'd	App'd	Description
M01	MAR 2023	DS	EOC	SMG	ISSUE FOR PHASE 4: PLANNING

Client <b>NTA</b> Údarás Náisiúnta Iompair National Transport Authority		Engineering Designer <b>CIROD</b> TYPSA		
Date MAR 2023	Scale 1:500 @ A1 1:1000 @ A3	Drawn DS	Checked EOC	Approved SMG
Programme Code BCIDD	Originator Code ROT	QMS Code		

Programme Title <b>BUSCONNECTS DUBLIN CORE BUS CORRIDORS INFRASTRUCTURE WORKS</b>			
Drawing Title RINGSEND TO CITY CENTRE CORE BUS CORRIDOR SCHEME GNI ASSET ALTERATIONS			
Drawing File Name BCIDD-ROT-UTL_UG-0016_XX_00-DR-CU-0012	Sheet Number 12 of 12	Status A	Rev M01

DO NOT SCALE USE FIGURED DIMENSIONS ONLY

\\nodub\p\U2019\17\17117-02\_WIP\08 MODELS\01 CAD\01 PLANNING\16 RINGSEND\BCIDD-ROT-UTL\_UG-0016\_XX\_00-DR-CU-001.dwg